

FORM No. 1.

River Courses beg^d at Walnute.

- N. 63 1/2 W. 10
- N. 52 W. 38.
- N. 34 1/2 W 30.
- N. 28 1/2 W 40.
- N. 25 W 34.
- N. 39 1/2 W 36
- Perches. 188 P^s

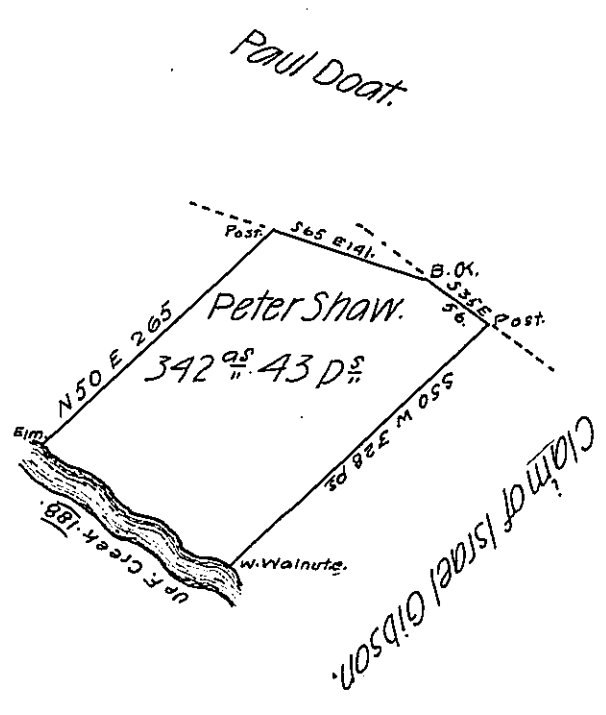

Situate on the East side of and adjoining French Creek in Allegheny County. Containing 342 Acres 43 perches and Allowance of Six p^t Cent for Roads &c. Surveyed the 14th day of October, 1797, for Peter Shaw. In pursuance of his Improvement, Bearing date the 16th day of October, 1795.

John Power, D. S^{vt}.

To Daniel Brodhead, Esquire.
Surveyor General.

IN TESTIMONY that the above is a copy of the original remaining on file in the Department of Internal Affairs of Pennsylvania, made conformably to an Act of Assembly approved the 16th day of February, 1833, I have hereunto set my Hand and caused the Seal of said Department to be affixed at Harrisburg, this ninth day of September, 1906.

Isaac D. Brown
Secretary of Internal Affairs.